

# SERVICE BULLETIN

## Large Air Motor Change

MODELS AFFECTED: 10" (66651), 12" (66506)  
REPLACEMENT VALVE ASM.: 637111

RELEASED: 9-1-98  
REVISED: 1-10-12  
BULLETIN: #3-98  
FORM: 4298-2  
REV: 01

Changes affect motors manufactured after August 1, 1998.

These part changes improve the outer seal on the Major Valve Gland.  
The following changes can be made to update older motors.

**NOTICE:**

- The gland has a different design.
- The quad ring has been replaced by a Buna O-ring.
- The washer is thicker, it moves the gland away from the exhaust outlet.

### OLD DESIGN

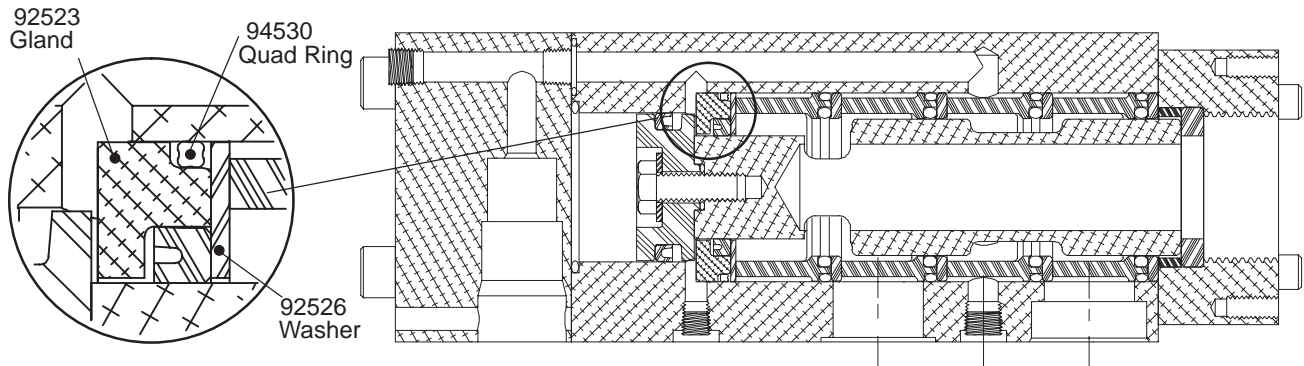

### NEW DESIGN

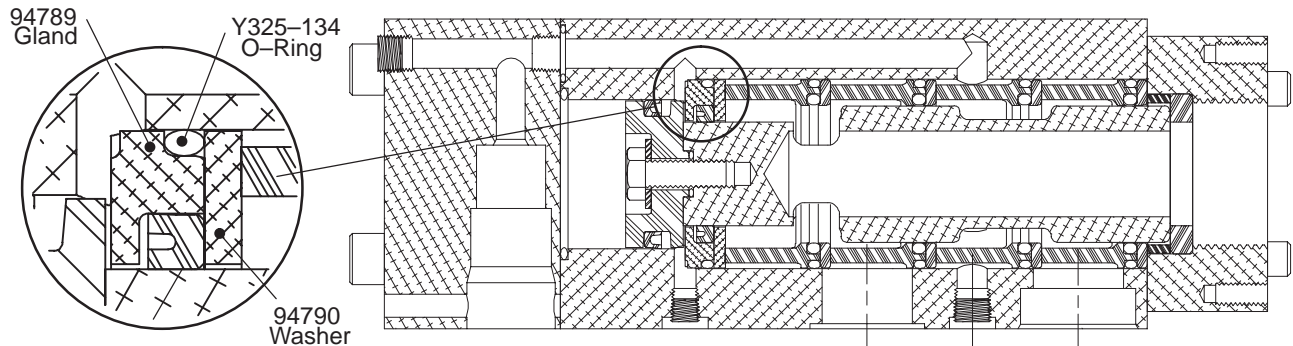

PN 97999-1593

**INGERSOLL RAND COMPANY LTD**  
209 NORTH MAIN STREET - BRYAN, OHIO 43506  
(800) 495-0276 • FAX(800) 892-6276  
www.ingersollrandproducts.com

© 2012 CCN 46735007

**ARO**   
Industrial Technologies